



LEE CHADWICK

SOLICITORS LLP
& ESTATE AGENTS



Farriers Court

Waine Rush View Witney

Price £280,000

Telephone 01993 703272 Email kr@lee-chadwick.co.uk

www.lee-chadwick.co.uk

Local Authority: West Oxfordshire District Council

Council Tax Band: D for 2022/2023 - Tenure: Leasehold

A Spacious 2 Bedroom Ground Floor Flat with Parking in the Popular Market Town of Witney.

The property comprises:

- Entrance Hall
- Burglar Alarm
- Fitted Kitchen
- Sitting Room with electric effect Woodburner and Patio Doors to Rear
- Main Bedroom with Fitted Wardrobes and Ensuite
- Second Bedroom with Fitted Wardrobes
- Bathroom
- Rear Garden

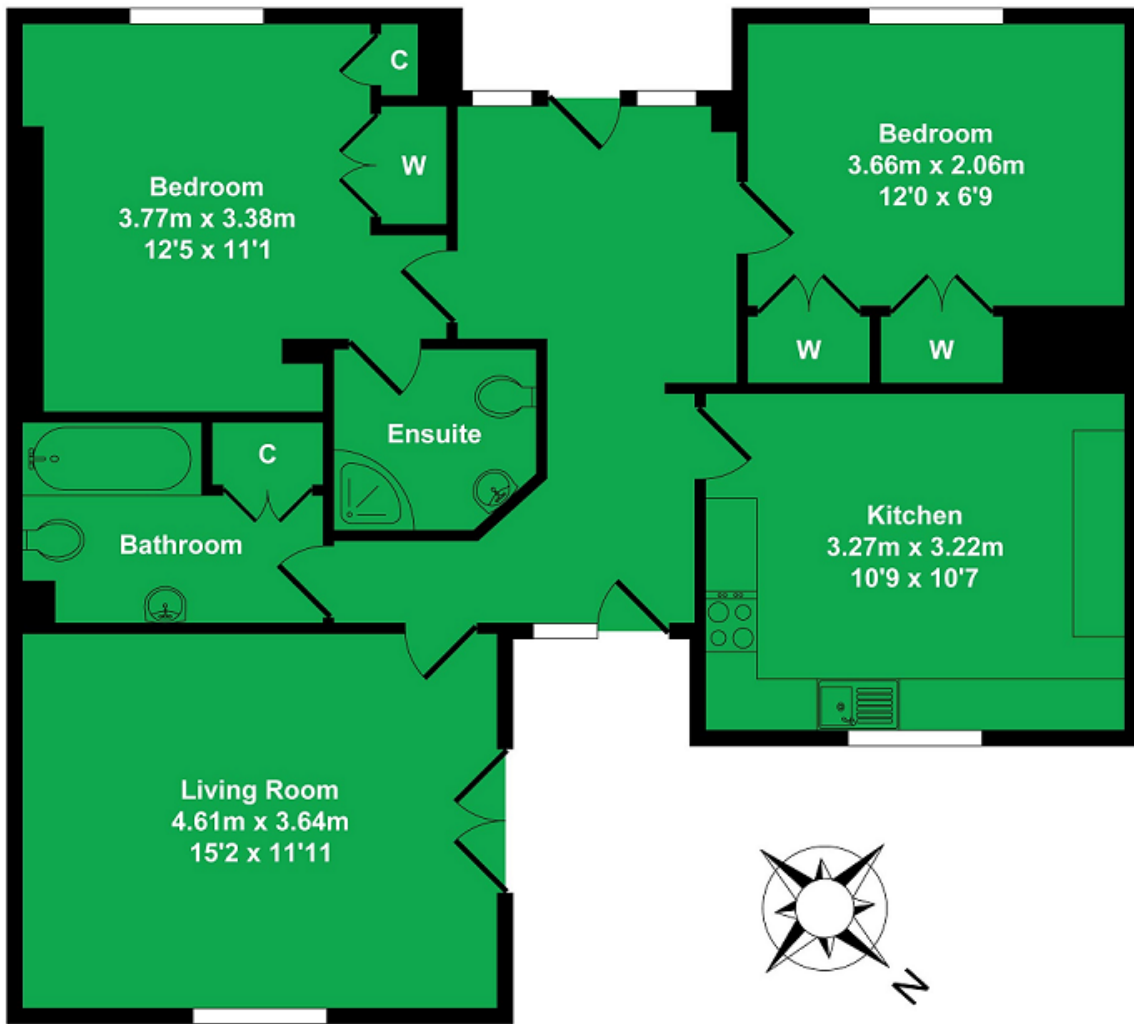

Total Approx. Floor Area 876 Sq.Ft. (81.40 Sq.M.)















Witney is a Popular Market Town in the Cotswolds and the property is situated within easy access to the Town Centre and within walking distance of local shops and amenities.

Disclaimer: Lee Chadwick endeavours to ensure that the floorplans, measurements and descriptions are accurate but cannot accept any responsibility for any errors, misstatements or omissions. In any event all measurements are approximate and these particulars are intended for guidance purposes only. Wide angled lenses may have been used for the photography. Lee Chadwick has not tested any appliances and purchasers should not assume that any reference to them means that they are included in the sale. It should not be assumed that any necessary planning or building regulation or listed building consents have been obtained. Any warranty or representation in relation to the property may not be relied upon. These particulars may not be included or relied upon in any offer nor may they form part of any contract. Purchasers must rely on their own inspection, legal enquiry and survey in all respects

Our ref: KR/AND03